

The Type 25 PointDrain provides a durable drain solution in areas where ponding or excess water may collect.

Polymer concrete is a versatile composite material produced by mixing mineral aggregate with a resin binding agent. Polymer concrete outperforms HDPE in its compressive strength, ability to withstand freeze-thaw cycles and adverse weather conditions, ensuring a longer service life.

The basin is manufactured out of polymer concrete and has several outlet configurations for system flexibility along with a choice of grates suitable for either pedestrian or light vehicular traffic.

Suitable for pedestrian/light vehicle traffic applications such as:

- Gardens
- Patios
- Walkways
- Driveways



## Product Overview

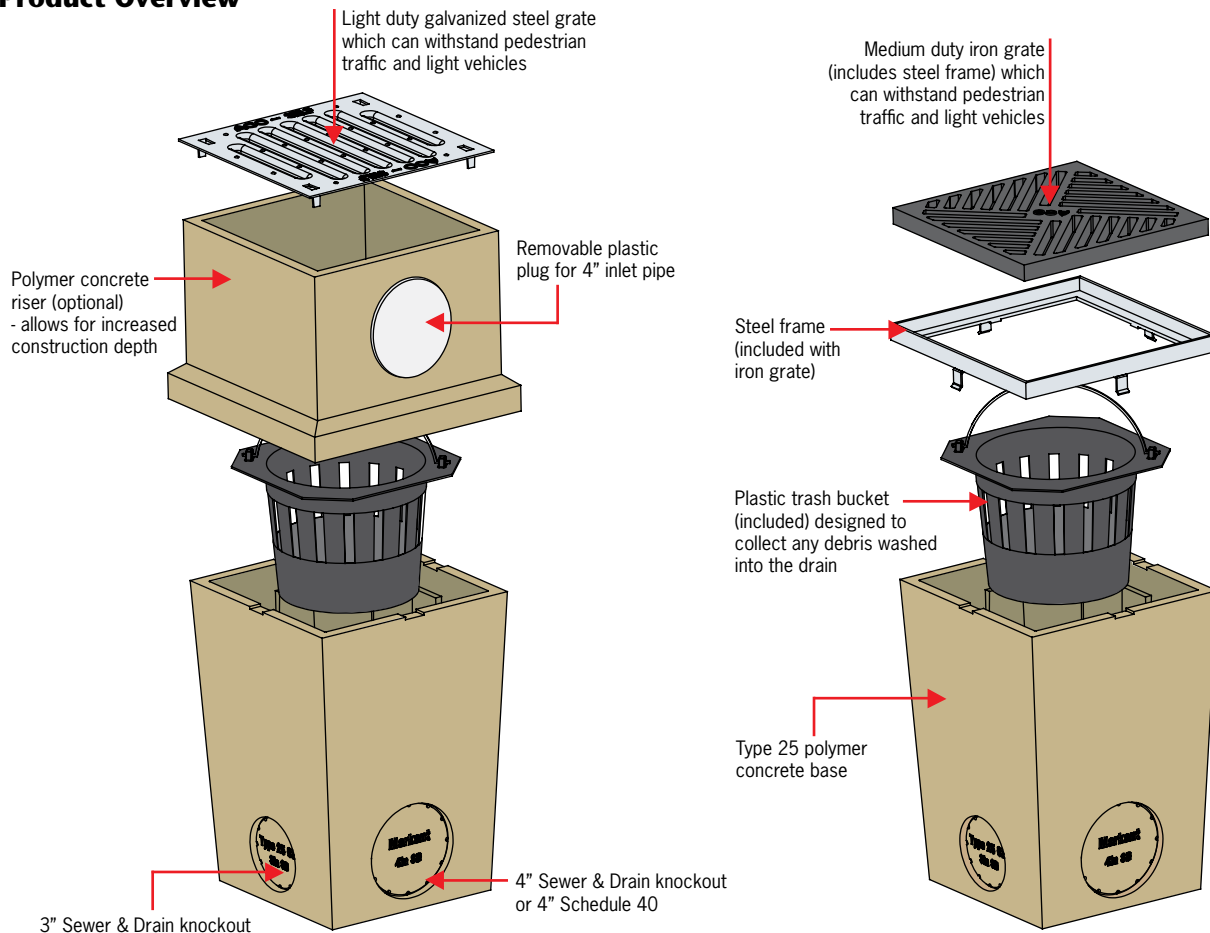

## Part Table

	Part No.	Length inches	Width inches	Height inches	Wgt. lbs
Type 25 with galv. grate	<b>01583</b>	9.8	9.8	13.7	30.8
Type 25 with frame & iron grate	<b>36893</b>	9.8	9.8	14.2	37.4
Type 25 riser	<b>02102</b>	9.8	9.8	7.8	12.5

## Installation Instructions



1 Dig hole to fit PointDrain and necessary pipe-work.



2 Drill out/cutout holes for pipe connection.



3 Position PointDrain on a 4" thick concrete slurry bed and ensure it is level.



4 Connect drainage pipe, check for leaks before backfilling.



5 Add riser (if required) and connect inlet pipe (if required). Surround PointDrain with good quality concrete. Finish with surfacing material.



6 Ensure finished surface is 1/8" higher than the grate to assist water drainage.

### ACO Polymer Products, Inc.

#### East Sales Office

P.O. Box 245  
Chardon, OH 44024  
Tel: (440) 285-7000  
Toll free: (800) 543-4764  
Fax: (440) 285-7005

#### West Sales Office

P.O. Box 12067  
Casa Grande, AZ 85130  
Tel: (520) 421-9988  
Toll Free: (888) 490-9552  
Fax: (520) 421-9899

#### Electronic Contact

info@acomarkant.com  
www.acomarkant.com

#### Follow us on

